



📍 ELENZA VIBE, NR. KAVISHA PANORAMA, SAFAL PARISAR ROAD, SOUTH BOPAL, AHMEDABAD-380058
☎ 70699 99059



PR/GJ/AHMEDABAD/DASKROI/
AHMEDABAD MUNICIPAL CORPORATION/
MAA14455/301124/300628
WWW.GUJRERA.GUJARAT.GOV.IN

ARCHITECT
RAJESH DARJI

STRUCTURE



10.11 design > 99511365

THE VIBE
OF CLASSINESS



3 BHK LIVING & SHOPS

THE *Vibe* THAT CAPTIVATES AT FIRST GLANCE

THE MOST PREMIUM **3 BHK RESIDENCES IN SHELA** EMBODY A PERFECT BLEND OF ELEGANCE AND PURPOSE. MASTERFULLY DESIGNED SPACES, ARTFULLY DETAILED INTERIORS, AND STATE-OF-THE-ART AMENITIES CREATE A LIVING EXPERIENCE THAT'S AS LUXURIOUS AS IT IS FUNCTIONAL.

SURROUNDED BY PEACEFUL LANDSCAPES AND STRATEGICALLY LOCATED FOR CONVENIENCE, THESE HOMES SET A NEW BENCHMARK FOR SOPHISTICATED LIVING.

G+13
STOREY

127
UNITS

3 BHK



A *Vibe* OF PRECISE PERFECTION

24
SHOPS





THE *Vibe* THAT NURTURES YOUR SOUL 

20+ LIFESTYLE AMENITIES



AMENITIES THAT MATCH TO YOUR

Vibe

CLUB HOUSE

INDOOR GAME

GYM

SAND PIT

CHILDREN PLAY

GARDEN

SENIOR CITIZEN SITTING

OPEN AREA

DROP OF ZONE

YOGA DECK

VERANDA

PLANTER

ENTRANCE FOYER

SECURITY CABIN

SOLAR PANEL

FIRE SYSTEM

CCTV CAMERA

POWER BACK UP



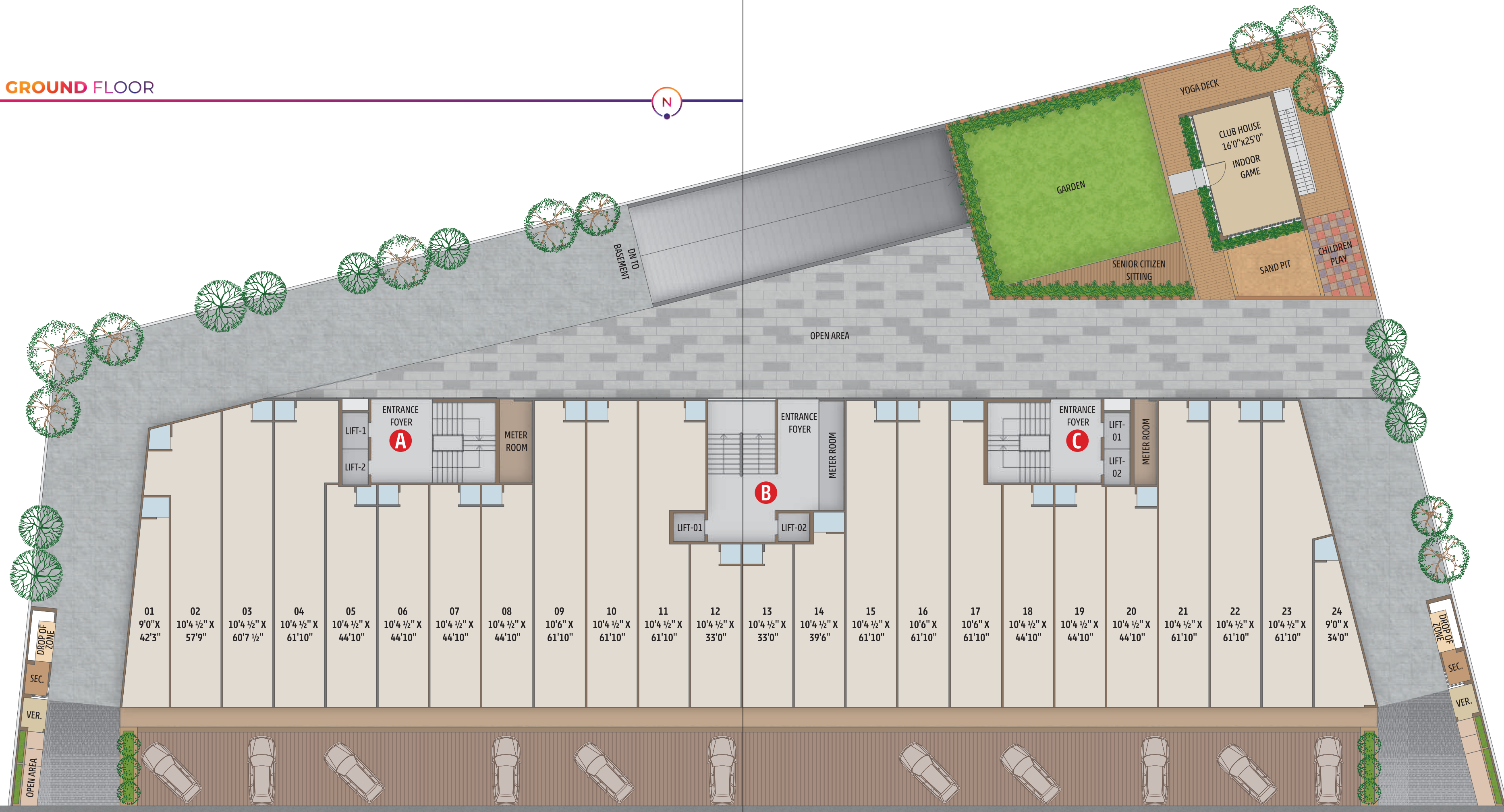

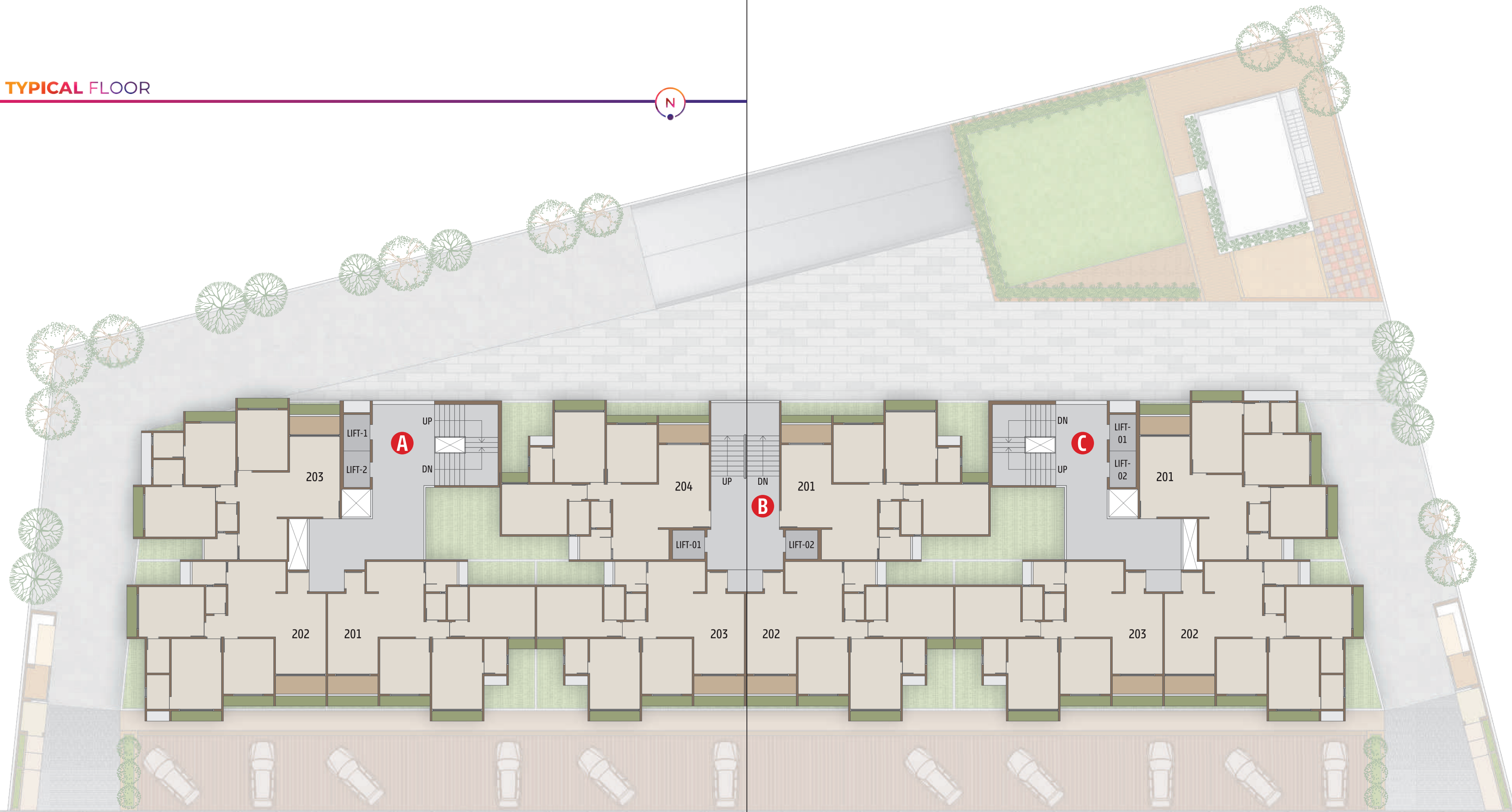

24 MTR. ROAD



3BHK

BLOCK-A
UNIT 103 TO 1203

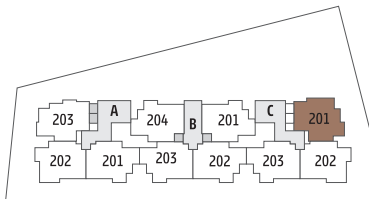
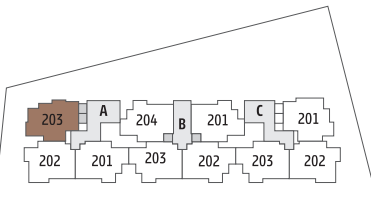

3BHK

BLOCK-B
UNIT 101 TO 1201
UNIT 104 TO 1204





3BHK

BLOCK-C
UNIT 101 TO 1301

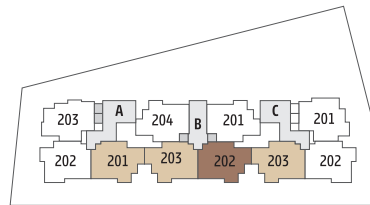
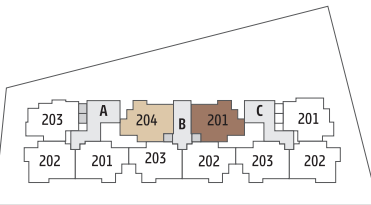

3BHK

BLOCK-A
UNIT 101 TO 1301

BLOCK-B
UNIT 102 TO 1302
UNIT 103 TO 1303

BLOCK-C
UNIT 103 TO 1303





3BHK

BLOCK-A
UNIT 102 TO 1302

BLOCK-C
UNIT 102 TO 1302

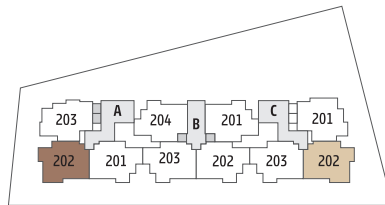

SET YOUR *Vibe* LIVE A LUXE LIFE





SPECIFICATIONS



WALL FINISH

- INTERNAL: SMOOTH FINISH MALA PLASTER WITH PUTTY.
- EXTERNAL: DOUBLE COAT SAND FACED PLASTER OR TEXTURE FINISH.

FLOORING

- VITRIFIED TILES FLOORING IN ALL ROOMS.

KITCHEN

- STANDING POLISHED NATURAL GRANITE KITCHEN PLATFORM WITH SINK & GLAZED TILES DADO ABOVE THE PLATFORM UP TO LINTEL LEVEL.

DOORS

- DECORATIVE MAIN DOOR HAVING LOCK OF REPUTED COMPANY.
- INTERNAL LAMINATED FLUSH DOORS

WINDOWS

- ALUMINIUM SECTION SLIDING WINDOWS WITH GLASS & STONE JAMS.

TOILET

- CERAMIC TILES FLOORING IN ALL TOILETS, GLAZED TILES DADO.

PLUMBING

- CONCEALED PLUMBING OF GOOD QUALITY UPVC & CPVC PIPES, C.P. FITTINGS & SANITARY WARE OF REPUTED BRAND.

ELECTRIFICATION

- METER + MCB & ELCB TRIPPER WITH CONCEALED WIRING AND ADEQUATE POINTS WITH QUALITY FITTINGS.

PAINT

- EXTERIOR ACRYLIC PAINT.
- INTERNAL WALLS PUTTY FINISH.



RULES & REGULATIONS • Stamp Duty, Registration Charges, Legal Documentation Charges, GST, Maintenance Deposit and any other charges shall be borne by buyer separately. • Any Additional charges of duties levied by government / local authority during or after the completion of the project will be borne by the buyer. • Internal changes shall be done with prior permission and shall be charged in advance. • Changes in external elevation shall not be permitted. • All rights reserved by the developer for alteration / modification / improvement in specification / changes in dimensions and planning shall be binding to all. • Business practices leading to pollution, causing material damage to the not allowed in the premises. • Irregular payments may attract interest or lead to cancellation of booking/s.

DISCLAIMER • This brochure and model are not part of any legal documents. • All dimensions / measurement given are unfinished and approximate. • The photographs & artistic impressions are for references only. Actual building may vary from the representations mentioned in the brochure. • This is not an advertisement within the meaning of RERA. This is not an offer, invitation or commitment of any nature. Recipients are advised to appraise themselves of the necessary and relevant information of the project prior to making any purchase decisions. All the specifications of the flat shall be as per the final agreement between the parties. • Subject to Ahmedabad jurisdiction only. • T&C Applicable